



Indimate
Quick Start Guide



IN THE BOX



Indimate
2nd Generation



Cable ties &
Doubled sided tape

WIRING DIAGRAM



Indimate 2nd Generation

Place securely in your bike, don't place device underneath thick metal

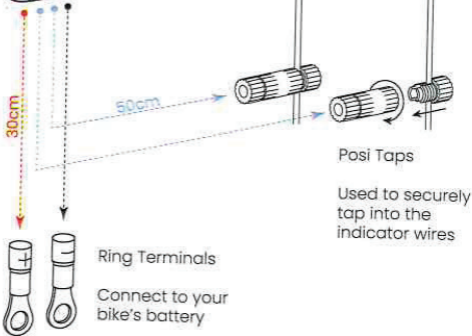

DISCLAIMER

To the maximum extent permitted by applicable law neither Indimate UG nor its suppliers, its subcontractors, its affiliates, officers, directors, employees, dealers or agents shall be liable to you or to any third party for any incidental damage including personal injury or any other damages, whether direct, special, incidental, indirect or consequential arising out of or related to:

- Indimate not working correctly.
- Any distractions caused by the Indimate device, or the associated smartphone application.
- Damage to the motorcycle due to improper installation and/or improper usage of Indimate.

Correct indicator usage is still the motorcyclist's responsibility, Indimate is only intended to assist the motorcyclist in this regard.

Read More at www.indimate.info

SUPPORT

If you have issues or questions regarding Indimate, visit the page below or send us an email at service@indimate.info



[Indimate.info/help](https://indimate.info/help)

We're happy to help!

STEP ONE

Find the positive wire of your indicators, the front or rears will work.



Positive Wire —
Usually any colour
other than black



STEP TWO

Tap the left and right indicator wires with the included Posi-Taps™.



STEP THREE

Screw the positive and negative connectors onto your battery.

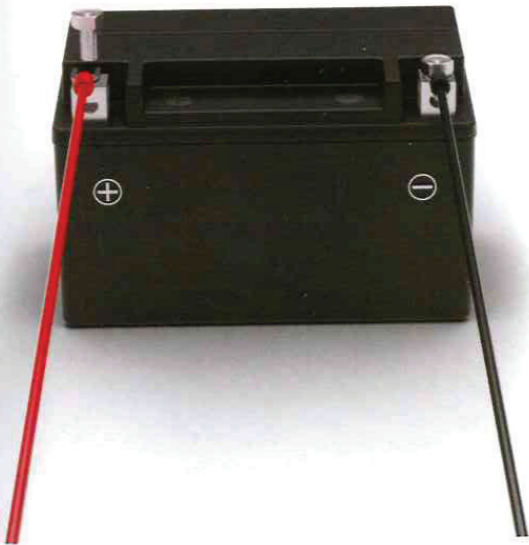

STEP FOUR

Securely position the Indimate device in your motorcycle.



STEP FIVE

Download the Indimate app and follow the setup instructions.



Scanning the QR Code
takes you to your device's
respective App Store

STEP SIX

Turn on an indicator to power the device up.
It will power off automatically when the app disconnects.

